

REV.	ECN NO.	OR DESCRIPTION	REVISED	DATE
A	PDR RELEASE		AMYC	2009.09.21
B	ECN NO:1.100016		WY-C	2010.04.08
C	ECN NO:1.100039		WY-C	2010.06.03
D	ECN NO:1.100087		WY-C	2010.09.03

**SPECIFICATIONS:**

1. OTHER GENERAL SPEC. TO REFER "HDMI SERIES SPEC".
2. TO CONFORM TO SINGATRON HAZARDOUS SUBSTANCE FREE SPEC.
3. PACKAGE : SEE "ZHE1540 SERIES" PACKAGE.
4. HALOGEN FREE PRODUCT IDENTIFICATION LABEL ON PACKAGING.
5. FOR REFLOW SOLDERING LEAD-FREE PROCESS.

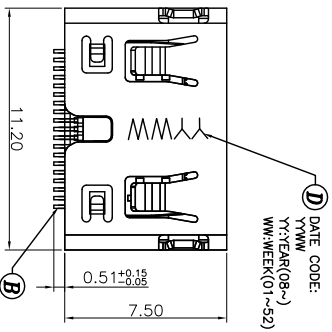
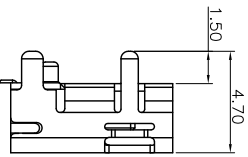
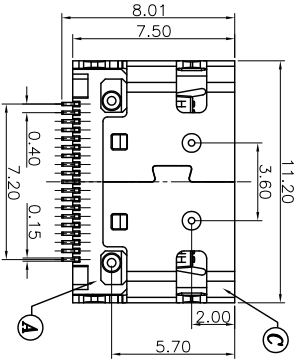
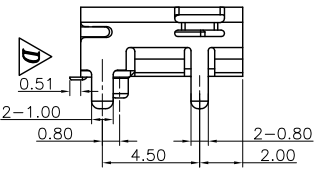
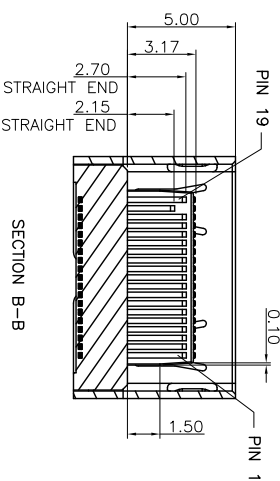
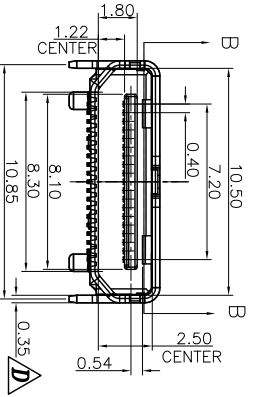

DATE CODE:  
 YWV  
 YY:YEAR(08~)  
 WW:WEEK(01~52)

**PART NO.**  
**ZHE1540-000111**

**PACKAGE & REEL**  
**1: TAPE & REEL**  
**HOUSING COLOR**  
**1: BLACK**  
**CONTACT PLATING**  
**1: GOLD 15u" ON CONTACT AREA**  
**AND TIN PLATING ON SOLDER AREA.**

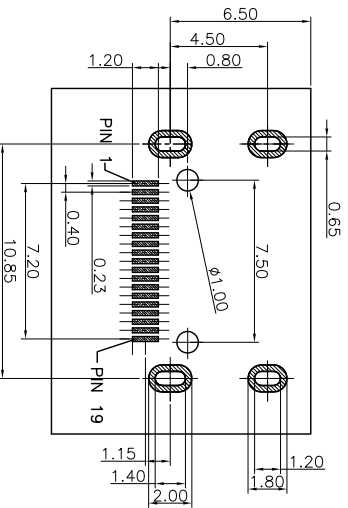

**RECOMMENDED PCB LAYOUT(TOP VIEW)**  
**(THICKNESS=0.8±0.05mm)**

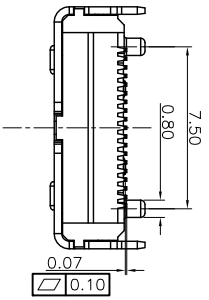

NO	DESCRIPTION	QTY	MATERIAL	PLATING & COLOR
D	INK	1		BLACK
C	SHELL	1	BRASS	NICKEL PLATING
B	CONTACT	19	PHOSPHOR BRONZE	50U 15U (ON CONTACT AREA AND TIN PLATING ON SOLDER AREA)
A	HOUSING	1	LCP, UL 94V-0	BLACK COLOR

UNLESS OTHERWISE SPECIFIED TOLERANCES

Singatron Enterprise Co., Ltd.  
 信音企業股份有限公司

DECIMALS: ANGLES:  
 X :±0.5 X :±2  
 X.X :±0.3 X.X :±1°  
 X.XX :±0.2

TITLE	HDMI TYPE C FEMALE, SMT,W/O FLANGE
DWN	HW-C-2010(09.03) PART NO.ZHE1540-000111
CHKD	HW-C-2010(09.03) SCALE:N/A UNIT: mm
APVD	HW-C-2010(09.03) SIZE: A3 SHEET:1 OF 1 REV: D

**CUSTOMER COPY**